



Art Form Architecture, LLC

HOPSCOTCH CLASSIC, 36X28

408.124.v48 GL

In addition to our Terms and Conditions (the "Terms"), please be aware of the following:

Art Form Architecture, LLC ("Artform") requires that our Drawings be built substantially as designed. Artform will not be obligated by or liable for use of this design with markups as part of any builder agreement. While we attempt to accommodate where possible and reasonable, and where the changes do not denigrate our design, any and all changes to Drawings must be approved in writing by Artform. It is recommended that you have your Drawing updated by Artform prior to attaching any Drawing to any builder agreement. Artform shall not be responsible for the misuse of or unauthorized alterations to any of its Drawings.



Width 60.00 ^{FT}

Depth 31.50 ^{FT}

Height 25.75 ^{FT}

LIVING AREA		2268 ^{FT}	BEDROOMS		5	BATHROOMS		3
Main		1958 ^{FT}	Main		4	Main		3
Future		310 ^{FT}	Future		1	Future		0
2 nd Unit		0 ^{FT}	2 nd Unit		0	2 nd Unit		0



Art Form Architecture, LLC

HOPSCOTCH CLASSIC, 36X28 - 1ST FLOOR 408.124.v48 GL

Some features shown are optional. Your Purchase & Sale Agreement governs, whether items are labeled "optional" in this document or not.

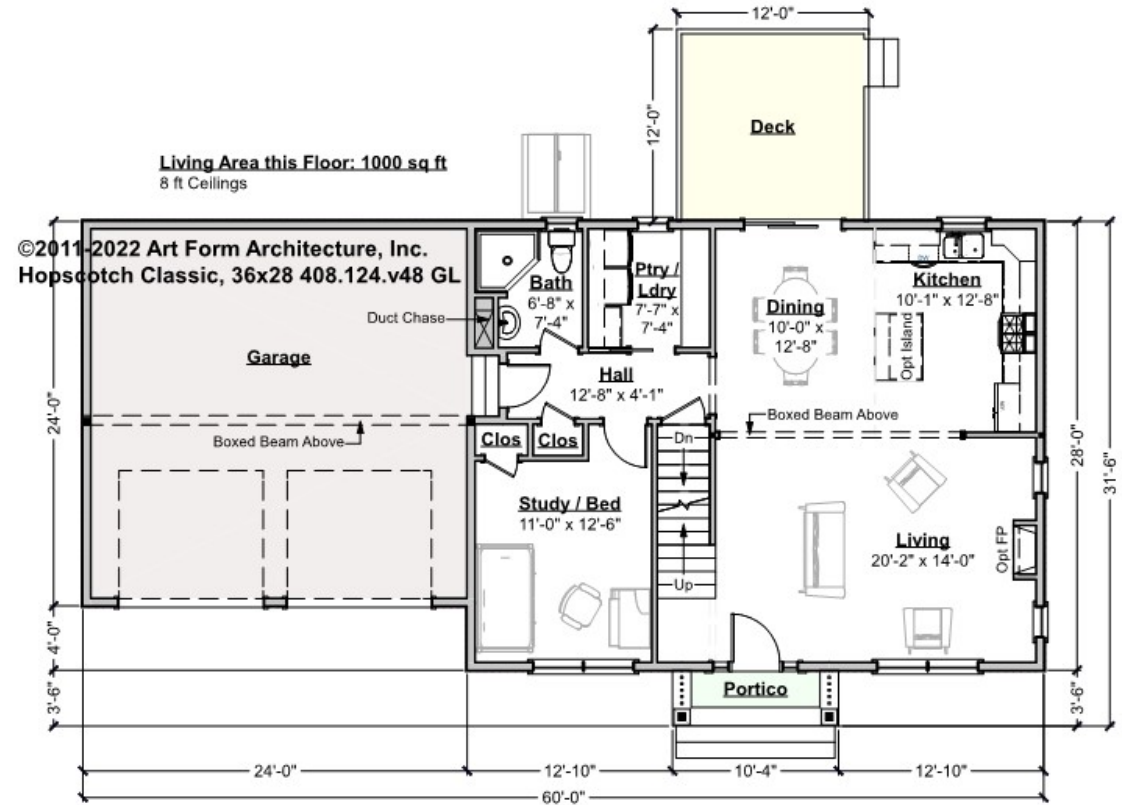

CLG HT SHOWN 8'-0"

CLG HT POSSIBLE 9'-0"

* Major Change Fee, see website plan page for cost

F1 LIVING AREA	1000 FT
Main	1000.00 FT
Future	FT
2 nd Unit	FT

F1 BEDROOMS	1
Main	1.00
Future	
2 nd Unit	

F1 BATHROOMS	1
Main	1.00
Future	
2 nd Unit	



HOPSCOTCH CLASSIC, 36X28 - 2ND FLOOR 408.124.v48 GL

Some features shown are optional. Your Purchase & Sale Agreement governs, whether items are labeled "optional" in this document or not.

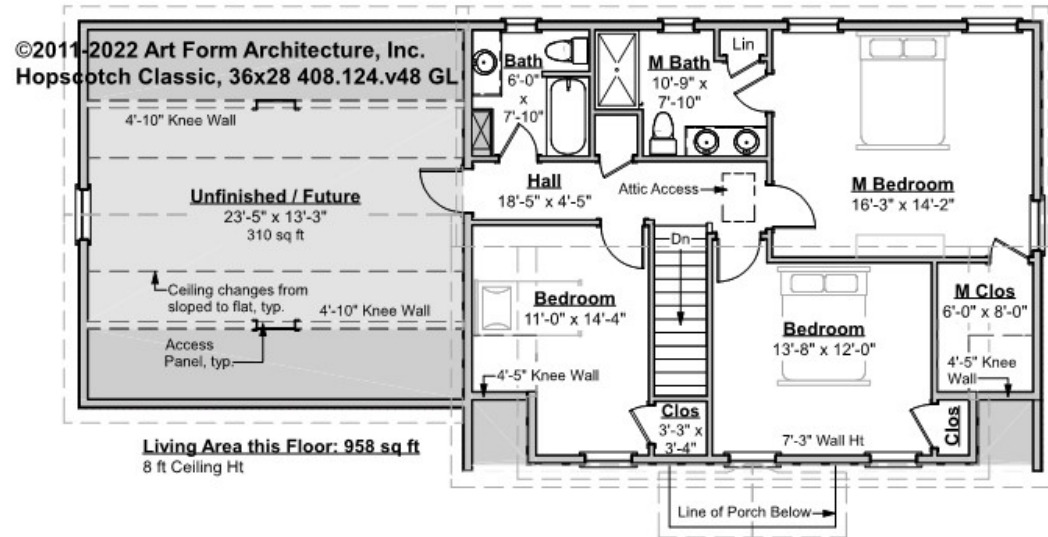

CLG HT SHOWN 8'-0"

CLG HT POSSIBLE 9'-0"

* Major Change Fee, see website plan page for cost

F1 LIVING AREA	1268 ^{FT}	F1 BEDROOMS	4	F1 BATHROOMS	2
Main	958.00 ^{FT}	Main	3.00	Main	2.00
Future	310.00 ^{FT}	Future	1.00	Future	
2 nd Unit	^{FT}	2 nd Unit		2 nd Unit	



HOPSCOTCH CLASSIC, 36X28 - BASEMENT 408.124.v48 GL

Some features shown are optional. Your Purchase & Sale Agreement governs, whether items are labeled "optional" in this document or not.

©2011-2022 Art Form Architecture, Inc.
Hopscotch Classic, 36x28 408.124.v48 GL

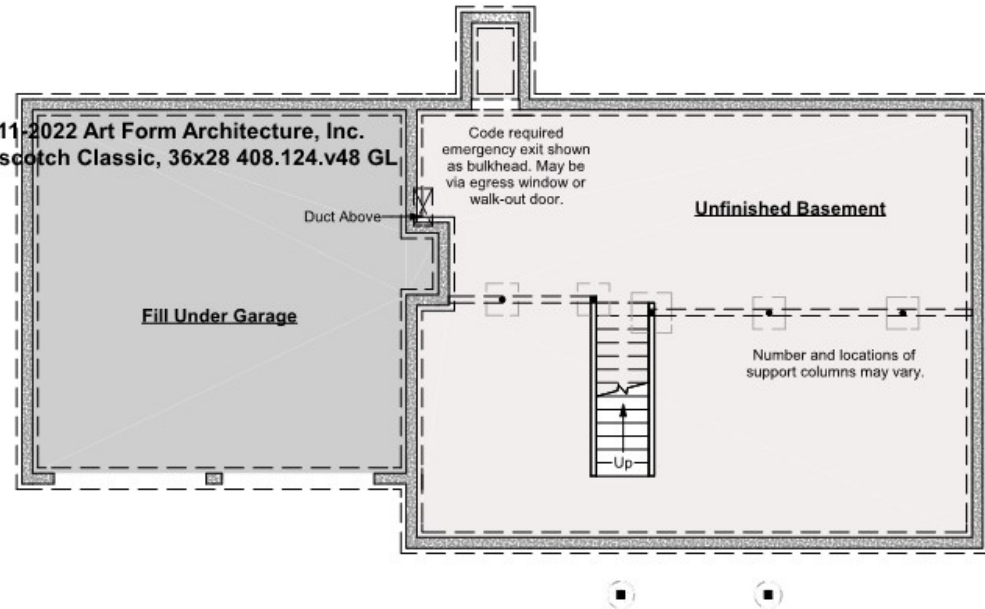

CLG HT SHOWN 7'-8"

CLG HT POSSIBLE 9'-0"

* Major Change Fee, see website plan page for cost

F1 LIVING AREA 0 FT

Main FT

Future FT

2nd Unit FT

F1 BEDROOMS 0

Main

Future

2nd Unit

F1 BATHROOMS 0

Main

Future

2nd Unit



Art Form Architecture, LLC

HOPSCOTCH CLASSIC, 36X28 - FRONT ELEVATION

408.124.v48 GL

Some features shown are optional. Your Purchase & Sale Agreement governs, whether items are labeled "optional" in this document or not.





Art Form Architecture, LLC

HOPSCOTCH CLASSIC, 36X28 - RIGHT ELEVATION

408.124.v48 GL

—
Some features shown are optional. Your Purchase & Sale Agreement governs, whether items are labeled "optional" in this document or not.





Art Form Architecture, LLC

HOPSCOTCH CLASSIC, 36X28 - REAR ELEVATION

408.124.v48 GL

—
Some features shown are optional. Your Purchase & Sale Agreement governs, whether items are labeled "optional" in this document or not.





Art Form Architecture, LLC

HOPSCOTCH CLASSIC, 36X28 - LEFT ELEVATION

408.124.v48 GL

—
Some features shown are optional. Your Purchase & Sale Agreement governs, whether items are labeled "optional" in this document or not.





Art Form Architecture, LLC

HOPSCOTCH CLASSIC, 36X28 - REAR RENDER

408.124.v48 GL

—

Some features shown are optional. Your Purchase & Sale Agreement governs, whether items are labeled "optional" in this document or not.

