

564.144 Raspberry Biscotti



Some features shown are optional. Your contract with your builder governs.



The Biscotti floor plan is a Ranch for a narrow lot. Notice that the master suite is well separated from the other two bedrooms.

See more plans in the [Berry Charming Ranches](#) Collection.

	Living Area	Bedrooms	Bathrooms	Ceiling Height Shown	Ceiling Height Possible*
First Floor	1604 SF	3	2.5	8'-0"	9'-0"
Total Above Grade	1604 SF	3	2.5		
Basement	0 SF	0	0.0	7'-8"	9'-0"

* -- See Major Changes on pricing tab of plan page for cost.
<http://www.artformhomeplans.com/Contact.a5w>
<http://www.artformhomeplans.com/TermsConditions.a5w>

Design is copyright protected, all rights reserved. You may not build without purchasing a license, even if you make changes. Square footages and room dimensions are approximate, and may vary slightly. Not responsible for typographical errors.

MEG 08/12/15 9:36AM EDT
JC 08/12/15 1:14PM EDT
dotloop signature verification: www.dotloop.com/my/verification/DL-117056587-5-1N3I

564.144 Raspberry Biscotti

Some features shown are optional. Your contract with your builder governs.

First Floor

Living Area: 1604 SF

Beds: 3

Baths: 2.5

Ceiling Height Shown: 8'-0"

Ceiling Height Possible*: 9'-0"

* -- See Major Changes on pricing tab of plan page for cost.

The master bedroom wing in the rear can be expanded as much as your lot and budget allow. This plan also expands to the right if you have room on your lot.

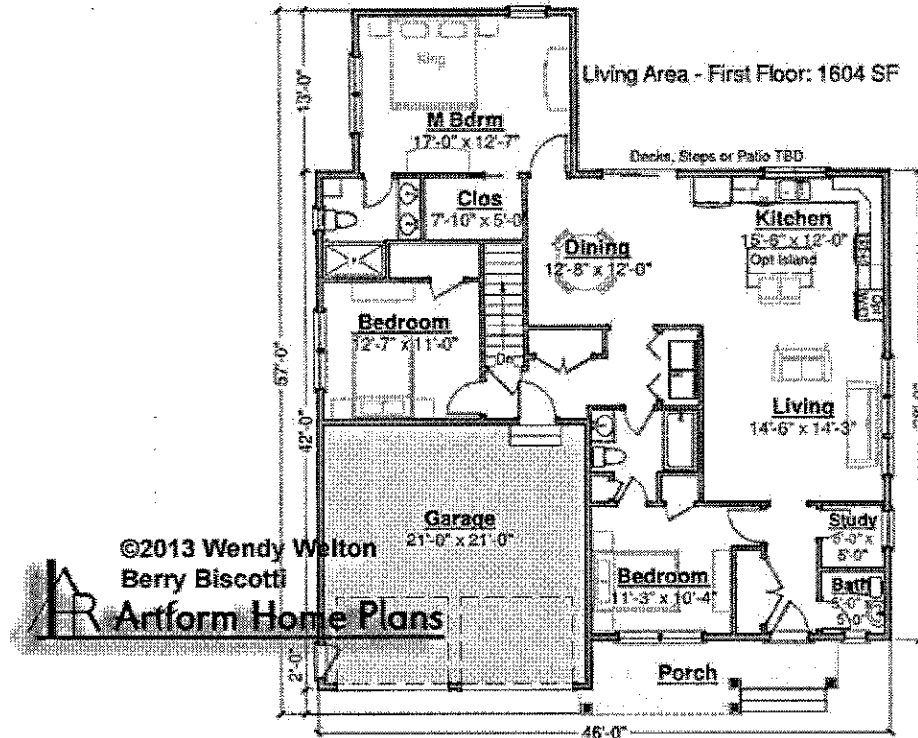

- gas fireplace
- Tray ceiling in LVG OR MSTR
- make LVG larger
- remove 1/2 Bath