

LEGEND

BH	BULKHEAD
□	CATCH BASIN
⊙	DRAIN MANHOLE
FS	FIRE SERVICE
FF	FIRST FLOOR
GF	GARAGE FLOOR
GS	GAS SERVICE
SS	SEWER SERVICE
⊙ SMH	SEWER MANHOLE
SGC	SLOPED GRANITE CURB
⊙	STORMCEPTOR
●	UTILITY STUB (EXIST)
WS	WATER SERVICE (DOMESTIC)

SEWAGE FLOWS:

#1 3 BR
#3 2 BR
#5 2 BR
#7 3 BR

10 BEDROOMS x 110 GPD/BR
= 1,100 GPD

UTILITY NOTES:

1. EACH BUILDING WILL HAVE ONE (1) 2" DOMESTIC SERVICE LINE TO 2" WITH METER AND (1) 4" FIRE SERVICE. FIRE SERVICE TO BE DESIGNED BY A REGISTERED DESIGN PROFESSIONAL.
2. THE SEWER SERVICE SHALL BE A 6" PVC PIPE AND LAID AT A MINIMUM SLOPE OF 2%.
3. CONTRACTOR SHALL CONTACT THE WOBURN DPW AND ENGINEERING DEPARTMENT 24 HOURS PRIOR TO CONNECTING INTO EXISTING UTILITIES WITHIN THE ROAD.
4. THE EXISTING SEWER AND WATER STUBS WERE FIELD LOCATED BY COMMONWEALTH ENGINEERING INC. THE CITY OF WOBURN DPW (WATER AND SEWER DEPARTMENT) AND THE ENGINEERING DEPARTMENT SHALL WITNESS THE CONNECTION OF THE SERVICE TO THE HOUSE.

BENCHMARK NOTE:

ELEVATIONS ARE BASED ON EXISTING CONDITIONS PLAN BY COMMONWEALTH ENGINEERING INC., DATED 01/28/01

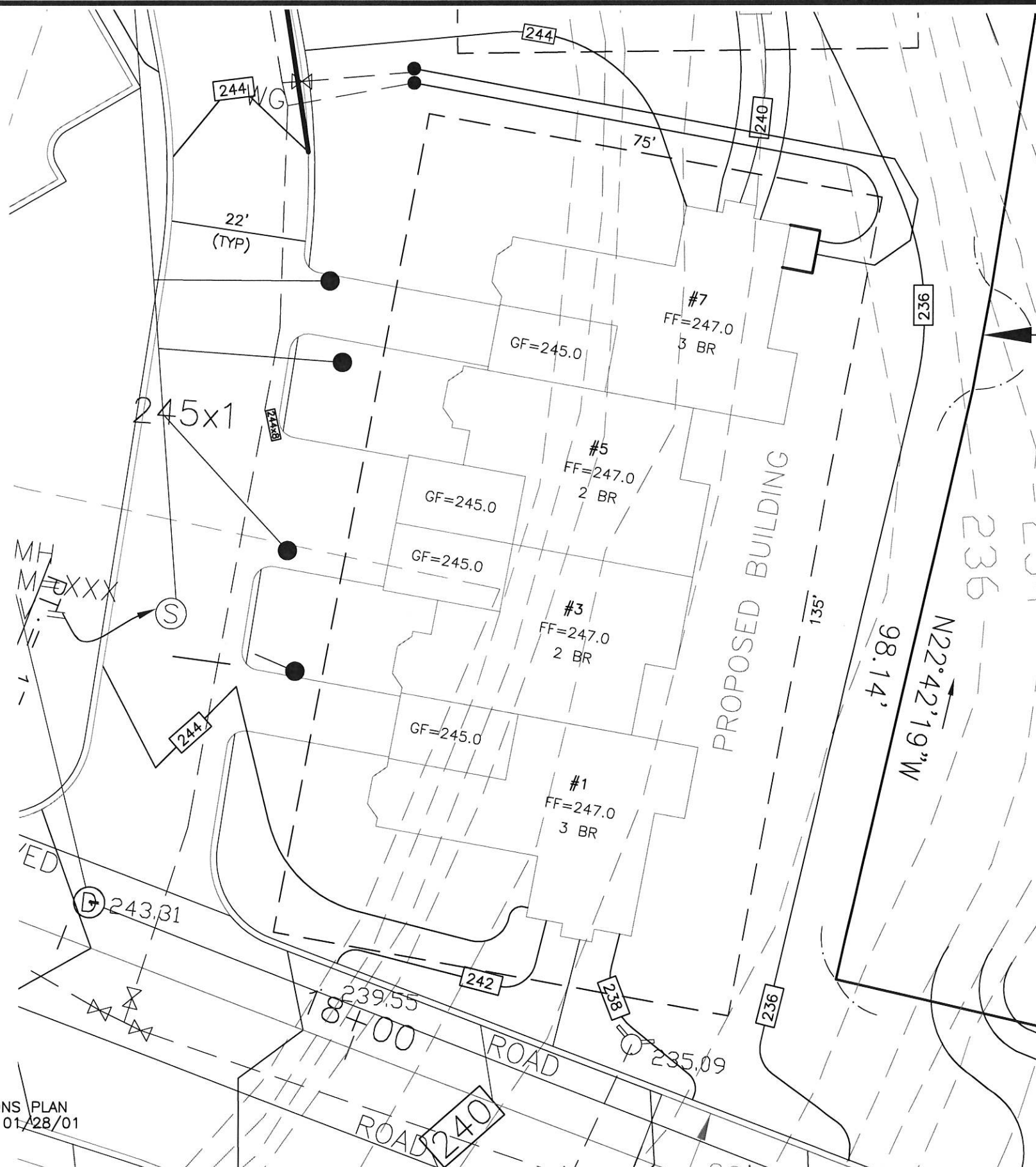

COMMONWEALTH
ENGINEERING
INC.

CIVIL ENGINEERS & LAND SURVEYORS

27 CAMBRIDGE STREET
SUITE 106
BURLINGTON, MA 01803
TEL (781) 229-0411
FAX (781) 229-0520
WWW.COMMONENG.COM

ADDRESS OF PROPERTY

1, 3, 5, & 7 PADDOCK LANE
WOBURN, MA

OWNER OF RECORD

WEST WOBURN DEVELOPMENT CORP
27 CAMBRIDGE STREET
BURLINGTON, MA 01803

DEED REFERENCE

DEED BOOK 46935 PAGE 115

ASSESSORS MAP REFERENCE

MAP 81 BLOCK 6 PARCEL 11

ZONING CLASSIFICATION

R-1

PLAN REFERENCE

PLAN 92 OF 2006
L.C.P. 20756H
L.C.P. 13932W
ANR PLAN BY RON NATOLI, JANUARY 4, 1996

NOVEMBER 12, 2021

PROPOSED PLOT PLAN

#1, #3, #5, #7 PADDOCK LANE
WOBURN, MA

SCALE:



DRAWN: ERN/DNR

CHECKED: DNR/DDO

FILE PATH (H: /PROJ/96-001.20):

\\DWG\\PLOTPLANS\\PADDOCKLANE\\1-7.DWG

JOB NO.:
196001.20

SHEET:
1